



15 Spencer Close

Aldershot, GU12 4DG

Asking Price £160,000

This well-presented, south-facing first-floor apartment offers bright and spacious accommodation throughout.

The property features a generous lounge, a spacious double bedroom, a separate fitted kitchen, and a well-maintained bathroom, all complemented by double glazing and gas central heating via radiators.

Externally, the development benefits from attractive communal gardens with bike storage facilities, as well as an allocated parking space for the apartment.

A particular advantage of the property is the comparatively low service charges when compared with many similar developments.

Ideally situated within walking distance of Aldershot town centre and the mainline railway station, the property also provides excellent access to major road links, including the A331, making it well suited for commuters.

Early viewing is highly recommended.

- Large double bedroom
- Spacious lounge
- South facing apartment
- Very convenient for the Railway Station/Town
- Allocated Parking Space
- 109 years left on Lease.
- Ground Rent £150 p/a.
- Service Charges £600 p/a.
- Council tax band B
- EPC energy rating band (C) 80

Viewing

Please contact our Fosters Sales Office on 01252 344333 if you wish to arrange a viewing appointment for this property or require further information.



Floor Plan

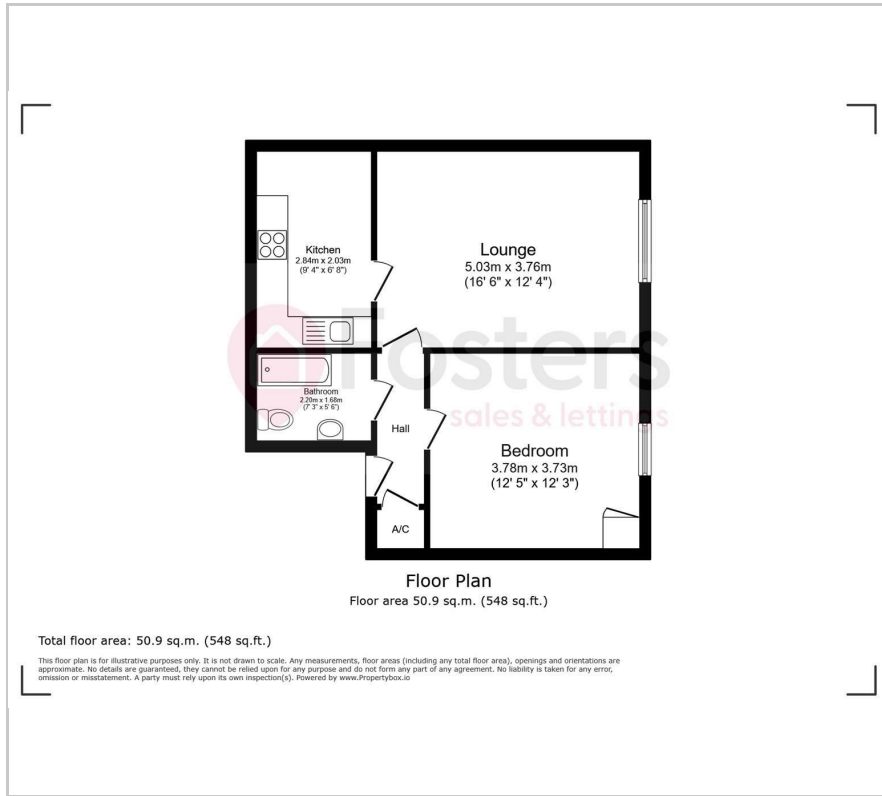

Area Map



Energy Efficiency Graph

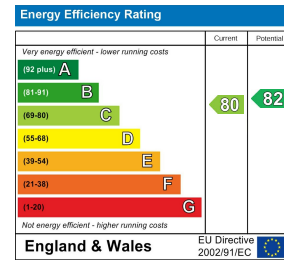

These particulars, whilst believed to be accurate are set out as a general outline only for guidance and do not constitute any part of an offer or contract. Intending purchasers should not rely on them as statements of representation of fact, but must satisfy themselves by inspection or otherwise as to their accuracy. No person in this firm's employment has the authority to make or give any representation or warranty in respect of the property.

14 Grosvenor Road, Aldershot, Hampshire, GU11 1DP

Tel: 01252 344333 Email: sales@fostersestateagents.com <https://fostersestateagents.com/>